



Electric Multistage Self-Priming Pump Type MHS

APPLICATIONS

- Domestic
- Industrial
- Irrigation
- General boosting

TECHNICAL DATA

- High pressure up to 8.0 bar
- Capacity up to 170 l/min (10.2m³/h)
- Low noise design
- Easy to assemble
- Max suction lift : - 6m
- Low weight & compact design
- Liquid temperature : 0 to +40°C

IDENTIFICATION CODE

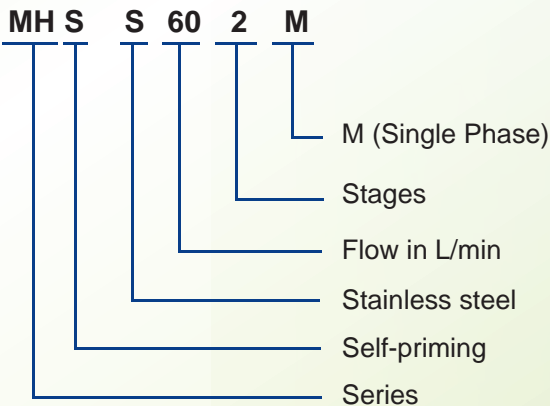

MATERIALS

- Pump body in AISI304 stainless steel
- Impellers in AISI304 stainless steel
- Inlet and outlet end caps : cast iron
- Mechanical seal in graphite/silicon carbide
- Voltages in Single phase : 220V-240V
Three phase : 380V-415V



PERFORMANCE CHART

60L/min

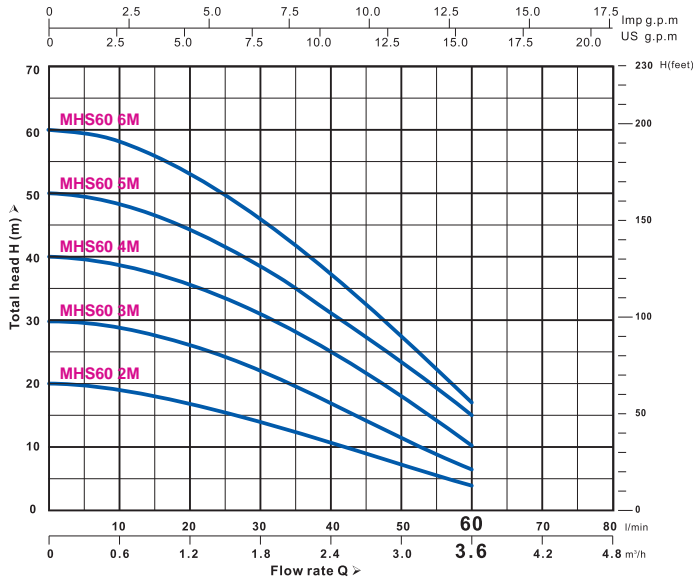

= 2850 min⁻¹

PUMP MODEL		MOTOR		Q	0	0.6	1.2	1.8	2.4	3.0	3.6
Single phase	Three phase	KW	HP	l/min	0	10	20	30	40	50	60
MHS60 2M	MHS60 2	0.37	0.5	H (m)	20	19	17	14	11	7	4
MHS60 3M	MHS60 3	0.5	0.65		30	29	26	22	17	12	7
MHS60 4M	MHS60 4	0.7	0.95		40	39	35	31	25	18	10
MHS60 5M	MHS60 5	0.85	1.15		50	48	44	38	31	24	15
MHS60 6M	MHS60 6	1.0	1.3		60	58	53	46	37	28	17

Q=FLOW RATE H=TOTAL DYNAMIC HEAD IN METERS

120L/min

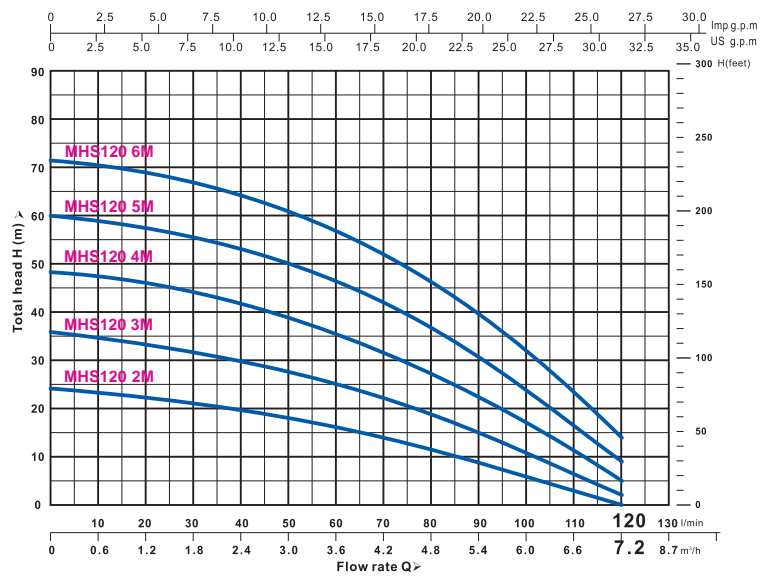

= 2850 min⁻¹

PUMP MODEL		MOTOR		Q	0	1.2	2.4	3.6	4.8	6.0	7.2
Single phase	Three phase	KW	HP	l/min	0	20	40	60	80	100	120
MHS120 2M	MHS120 2	0.55	0.75	H (m)	24	22	20	17	12	6	0
MHS120 3M	MHS120 3	0.75	1.0		36	33	30	25	18	11	2
MHS120 4M	MHS120 4	1.0	1.3		48	46	42	35	27	17	6
MHS120 5M	MHS120 5	1.3	1.65		60	58	53	46	37	24	10
MHS120 6M	MHS120 6	1.5	2.0		72	69	64	57	46	32	14

Q=FLOW RATE H=TOTAL DYNAMIC HEAD IN METERS

90L/min

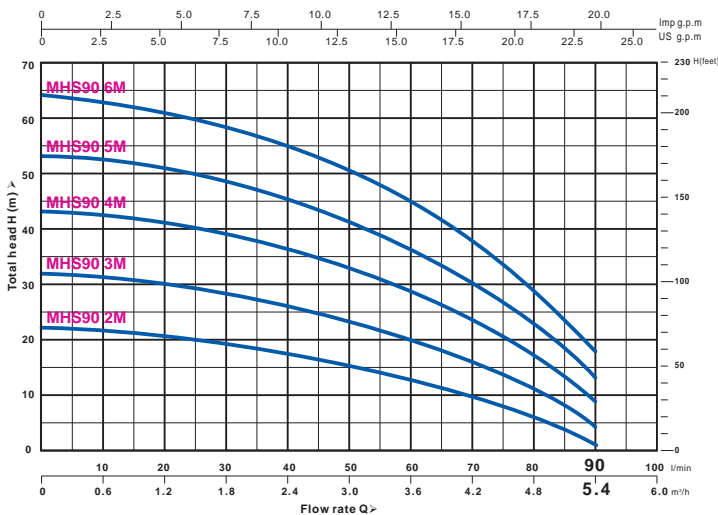

= 2850 min⁻¹

PUMP MODEL		MOTOR		Q	0	0.6	1.2	1.8	2.4	3.0	3.6	4.2	4.8	5.4
Single phase	Three phase	KW	HP	l/min	0	10	20	30	40	50	60	70	80	90
MHS90 2M	MHS90 2	0.45	0.6	H (m)	22	21	20	19	17	15	13	10	6	2
MHS90 3M	MHS90 3	0.75	0.95		32	31	30	28	26	23	20	16	11	4
MHS90 4M	MHS90 4	0.85	1.15		43	42	41	39	36	33	29	24	17	9
MHS90 5M	MHS90 5	1.05	1.4		53	52	51	49	45	41	36	30	23	13
MHS90 6M	MHS90 6	1.3	1.65		64	62	61	58	55	50	45	37	28	17

Q=FLOW RATE H=TOTAL DYNAMIC HEAD IN METERS

145L/min

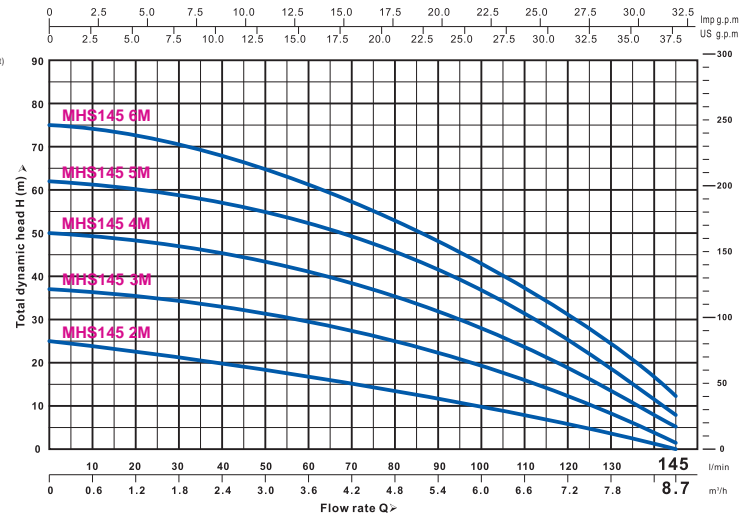

= 2850 min⁻¹

PUMP MODEL		MOTOR		Q	0	1.2	2.4	3.6	4.8	6.0	7.2	7.8	8.7
Single phase	Three phase	KW	HP	l/min	0	20	40	60	80	100	120	130	145
MHS145 2M	MHS145 2	0.7	0.95	H (m)	25	23	20	17	14	10	6	4	0
MHS145 3M	MHS145 3	0.95	1.25		37	35	33	30	25	19	13	8	2
MHS145 4M	MHS145 4	1.3	1.65		50	48	45	41	35	28	18	14	5
MHS145 5M	MHS145 5	1.5	2.0		62	60	57	52	46	37	25	19	7
MHS145 6M	MHS145 6	1.85	2.5		75	73	68	62	53	43	31	25	12

Q=FLOW RATE H=TOTAL DYNAMIC HEAD IN METERS

PERFORMANCE CHART

170L/min

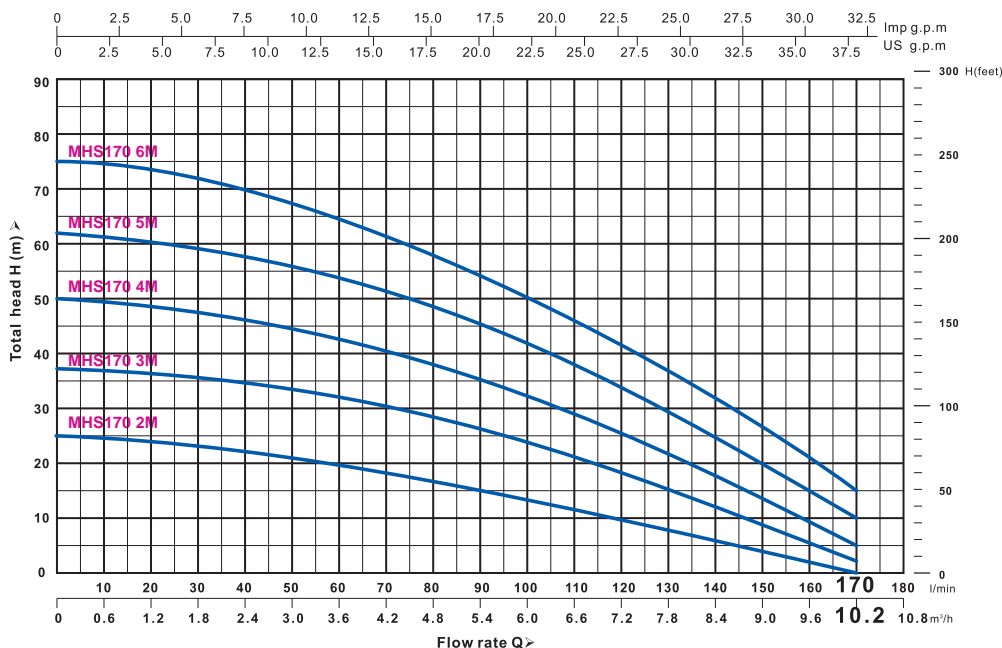

= 2850 min⁻¹

PUMP MODEL		MOTOR		Q	0	1.2	2.4	3.6	4.8	6.0	7.2	8.4	9.6	10.2
Single phase	Three phase	KW	HP	l/min	0	20	40	60	80	100	120	140	160	170
MHS170 2M	MHS170 2	0.75	1.0	H (m)	25	24	23	20	17	13	10	6	2	0
MHS170 3M	MHS170 3	1.1	1.45		37	36	35	32	28	23	18	12	6	2
MHS170 4M	MHS170 4	1.4	1.85		50	49	46	43	38	32	25	17	9	5
MHS170 5M	MHS170 5	1.65	2.2		62	60	58	54	48	42	34	25	15	10
MHS170 6M	MHS170 6	2.1	2.8		75	73	70	65	58	50	42	32	21	15

Q=FLOW RATE H=TOTAL DYNAMIC HEAD IN METERS

SECTIONAL VIEW

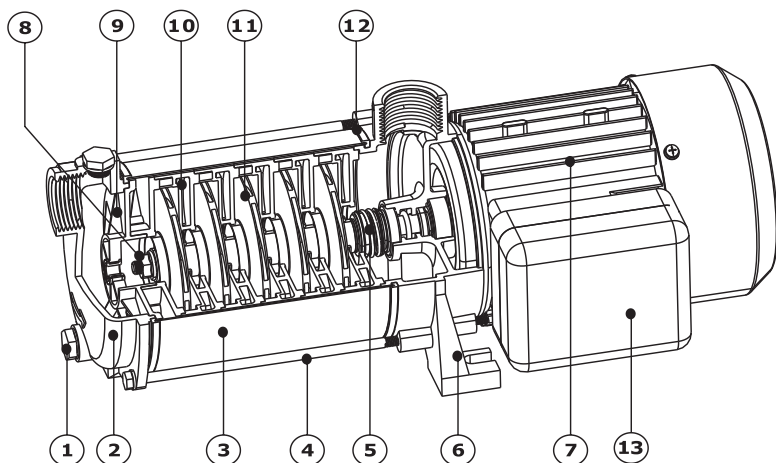

Item	Description	Item	Description
1	Prime and drain plugs	8	Nut
2	Suction mounting	9	Self-priming cover
3	Pump housing	10	Diffuser
4	Tie bolt	11	Impeller
5	Mechanical seal	12	Casing O-ring
6	Discharge mounting	13	Terminal box
7	Motor		

DIMENSION

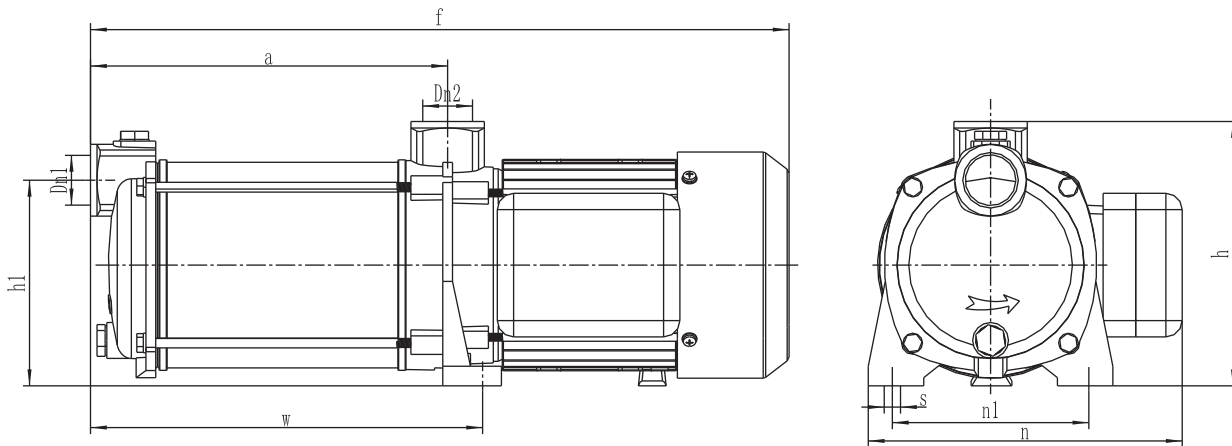

PUMP MODEL		Dn1	Dn2	DIMENSION [mm]									Weight (kg)
Single phase	Three phase			a	f	h	h1	h2	n	n1	w	s	
MHS 60 2M	MHS 60 2	1"	1"	146	334.5	192	122	32.5	150	120	164	10	8.5
MHS 60 3M	MHS 60 3	1"	1"	170.5	359	192	122	32.5	150	120	188.5	10	9.3
MHS 60 4M	MHS 60 4	1"	1"	194.5	407.5	204	126	36.5	150	120	214.5	10	11.6
MHS 60 5M	MHS 60 5	1"	1"	219	432	204	126	36.5	150	120	239	10	12.0
MHS 60 6M	MHS 60 6	1"	1"	243.5	456.5	204	126	36.5	150	120	263.5	10	13.6
MHS 90 2M	MHS 90 2	1"	1"	146	334.5	192	122	32.5	150	120	164	10	8.7
MHS 90 3M	MHS 90 3	1"	1"	170	383	204	126	36.5	150	120	190	10	11.1
MHS 90 4M	MHS 90 4	1"	1"	194.5	407.5	204	126	36.5	150	120	214.5	10	12.5
MHS 90 5M	MHS 90 5	1"	1"	219	432	204	126	36.5	150	120	239	10	13.9
MHS 90 6M	MHS 90 6	1"	1"	243.5	476.5	204	126	36.5	150	120	263.5	10	17.9
MHS 120 2M	MHS 120 2	1 1/4"	1"	145.5	358.5	204	126	36.5	150	120	165.5	10	11.1
MHS 120 3M	MHS 120 3	1 1/4"	1"	170	383	204	126	36.5	150	120	190	10	11.5
MHS 120 4M	MHS 120 4	1 1/4"	1"	194.5	407.5	204	126	36.5	150	120	214.5	10	13.3
MHS 120 5M	MHS 120 5	1 1/4"	1"	219	462	204	126	36.5	150	120	239	10	17.7
MHS 120 6M	MHS 120 6	1 1/4"	1"	246.5	484.5	234	142	41.5	169	130	278.5	12	19.2
MHS 145 2M	MHS 145 2	1 1/4"	1"	145.5	358.5	204	126	36.5	150	120	165.5	10	10.5
MHS 145 3M	MHS 145 3	1 1/4"	1"	170	383	204	126	36.5	150	120	190	10	12.4
MHS 145 4M	MHS 145 4	1 1/4"	1"	194.5	437.5	204	126	36.5	150	120	214.5	10	16.7
MHS 145 5M	MHS 145 5	1 1/4"	1"	222	460	234	142	41.5	169	130	254	12	18.8
MHS 145 6M	MHS 145 6	1 1/4"	1"	246.5	519	251	148.5	54.5	179	130	278.5	12	22.8
MHS 170 2M	MHS 170 2	1 1/4"	1 1/4"	149	363	204	126	36.5	150	120	170	10	12.6
MHS 170 3M	MHS 170 3	1 1/4"	1 1/4"	173.5	387.5	204	126	36.5	150	120	194.5	10	13.2
MHS 170 4M	MHS 170 4	1 1/4"	1 1/4"	197.5	435.5	234	142	41.5	169	130	229.5	12	18.0
MHS 170 5M	MHS 170 5	1 1/4"	1 1/4"	222	460	234	142	41.5	169	130	254	12	19.0
MHS 170 6M	MHS 170 6	1 1/4"	1 1/4"	247.5	524	251	148.5	54.5	179	130	279.5	12	22.8

* Dimensional details are provided for reference only.

* All specifications are subject to change without prior notice.



EBARA Pumps Malaysia Sdn Bhd

6, Jalan TP3, UEP Subang Jaya Industrial Park,
47620 Subang Jaya, Selangor, Malaysia.

Tel : 03-8023 6622 Fax : 03-8023 9355

Email : sales.epm@ebara.com

Website : www.ebara.com.my



Authorised dealer: