



## Automatic Booster Pump

Type JET-MHS BOOSTER

The **EBARA JET-MHS BOOSTER** pump is an automatic booster pump specially designed for domestic water pressurisation, commercial water supply and small industrial applications. It integrates the automatic pump controller unit to enhance optimal pumping operation. In addition, the pump can be equipped with a cover to improve its waterproof and ultraviolet protection ability for outdoor use, thus extend its service life.

### FEATURES

- Fully automatic control
- Self-priming function
- Protection against weather for outdoor use (with cover)
- Quiet operation
- User-friendly adjustable cut-in pressure
- Pressure display on controller unit
- Thermal overload protection available

### Product range at a glance

Models	Max. H	Max. Q
JET-MHS 60	60m	60L/min
JET-MHS 90	64m	90L/min
JET-MHS 120	69m	120L/min
JET-MHS 145	62m	145L/min
JET-MHS 170	62m	170L/min



**JET-MHS Booster unit  
(with pump cover)**

## PERFORMANCE CURVE

### JET-MHS 60

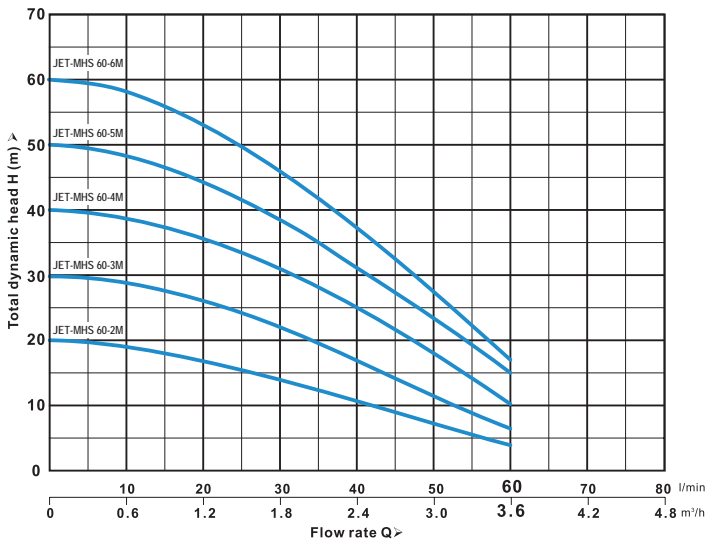

PUMP MODEL	OUTPUT		Q m³/h	Flow rate Q							
	KW	HP		0	0.6	1.2	1.8	2.4	3.0	3.6	
JET-MHS 60-2M	0.37	0.5	0	20	19	17	14	11	7	4	
JET-MHS 60-3M	0.5	0.65	10	30	29	26	22	17	12	7	
JET-MHS 60-4M	0.7	0.95	20	40	39	35	31	25	18	10	
JET-MHS 60-5M	0.85	1.15	30	50	48	44	38	31	24	15	
JET-MHS 60-6M	1.0	1.3	40	60	58	53	46	37	28	17	

### JET-MHS 90

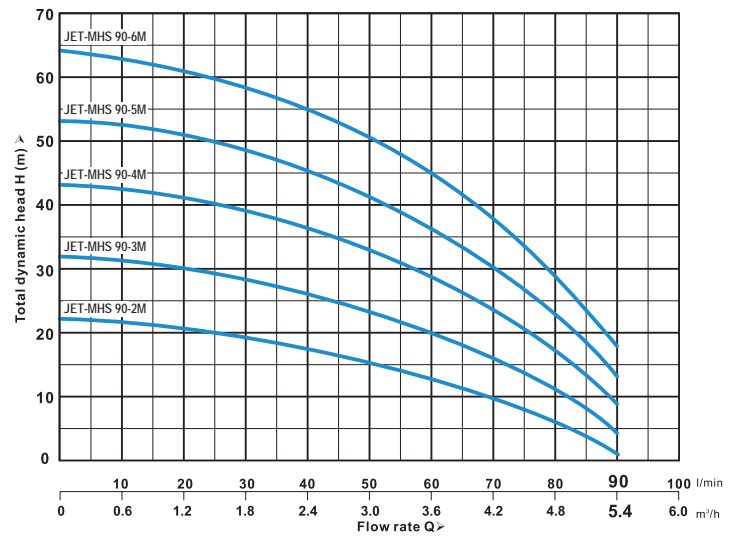

PUMP MODEL	OUTPUT		Q m³/h	Flow rate Q									
	KW	HP		0	0.6	1.2	1.8	2.4	3.0	3.6	4.2	4.8	5.4
JET-MHS 90-2M	0.45	0.6	0	22	21	20	19	17	15	13	10	6	2
JET-MHS 90-3M	0.75	0.95	10	32	31	30	28	26	23	20	16	11	4
JET-MHS 90-4M	0.85	1.15	20	43	42	41	39	36	33	29	24	17	9
JET-MHS 90-5M	1.05	1.4	30	53	52	51	49	45	41	36	30	23	13
JET-MHS 90-6M	1.3	1.65	40	64	62	61	58	55	50	45	37	28	17

### JET-MHS 120

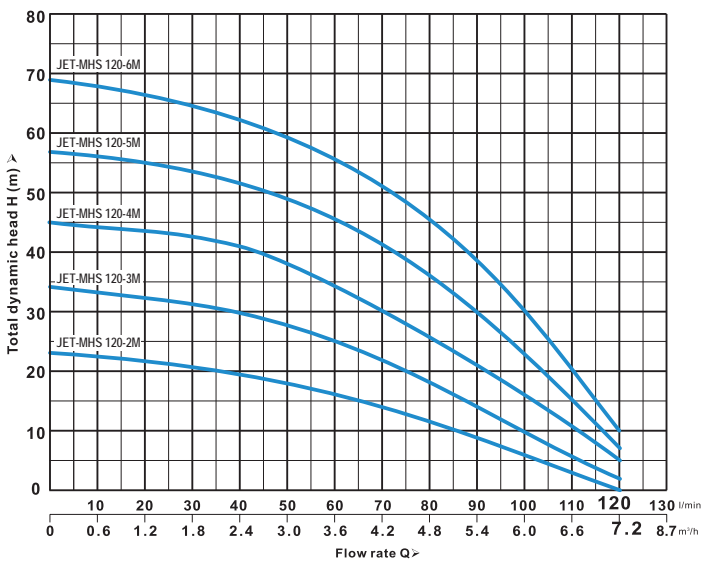

PUMP MODEL	OUTPUT		Q m³/h	Flow rate Q							
	KW	HP		0	1.2	2.4	3.6	4.8	6.0	7.2	
JET-MHS 120-2M	0.55	0.75	0	23	22	19	17	12	6	0	
JET-MHS 120-3M	0.75	1.0	10	34	32	30	25	18	10	2	
JET-MHS 120-4M	1.0	1.3	20	45	43	41	34	26	16	5	
JET-MHS 120-5M	1.3	1.65	30	57	55	52	45	36	22	7	
JET-MHS 120-6M	1.5	2.0	40	69	67	62	56	45	30	10	

### JET-MHS 145

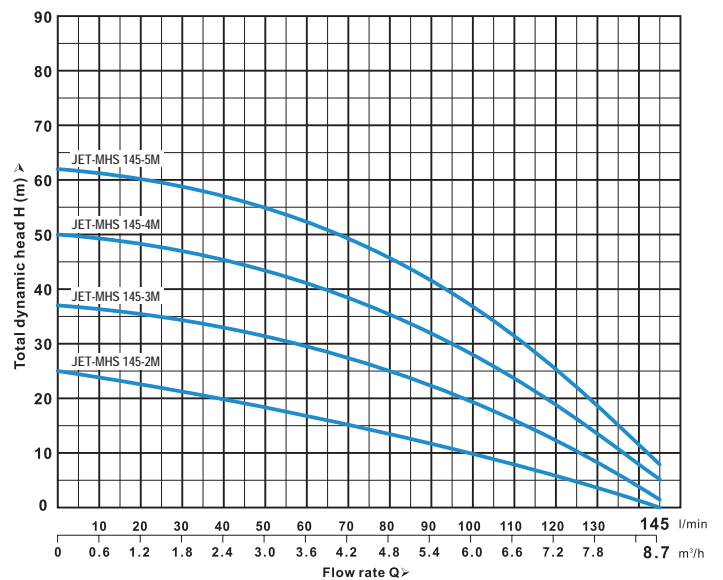

PUMP MODEL	OUTPUT		Q m³/h	Flow rate Q									
	KW	HP		0	1.2	2.4	3.6	4.8	6.0	7.2	7.8	8.7	
JET-MHS 145-2M	0.7	0.95	0	25	23	20	17	14	10	6	4	0	
JET-MHS 145-3M	0.95	1.25	10	37	35	33	30	25	19	13	8	2	
JET-MHS 145-4M	1.3	1.65	20	50	48	45	41	35	28	18	14	5	
JET-MHS 145-5M	1.5	2.0	30	62	60	57	52	46	37	25	19	7	

## PERFORMANCE CURVE

### JET-MHS 170

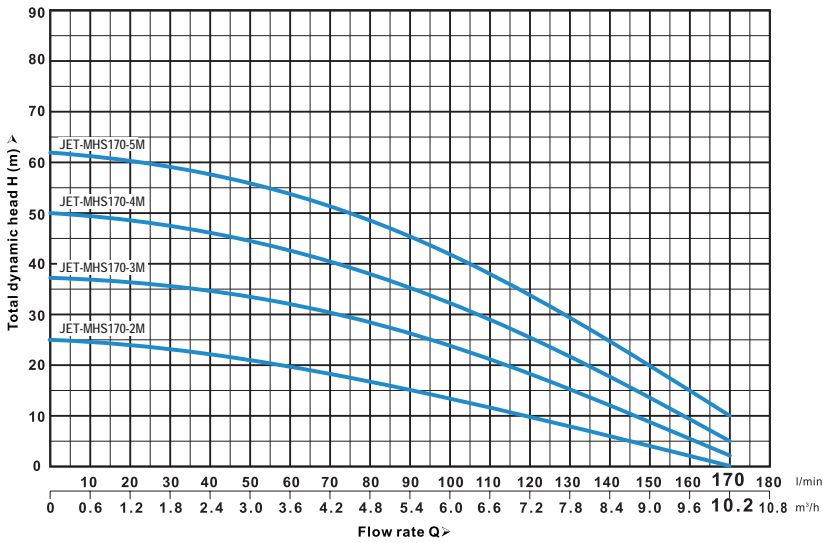

### Model Name description

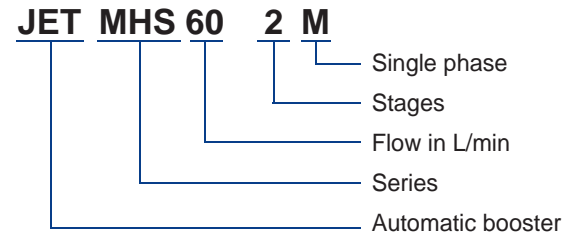

PUMP MODEL	OUTPUT		Q m³/h l/min	0	1.2	2.4	3.6	4.8	6.0	7.2	8.4	9.6	10.2
	KW	HP		0	20	40	60	80	100	120	140	160	170
JET-MHS170-2M	0.75	1.0	H (m)	25	24	23	20	17	13	10	6	2	0
JET-MHS170-3M	1.1	1.45		37	36	35	32	28	23	18	12	6	2
JET-MHS170-4M	1.4	1.85		50	49	46	43	38	32	25	17	9	5
JET-MHS170-5M	1.65	2.2		62	60	58	54	48	42	34	25	15	10

## SECTIONAL VIEW

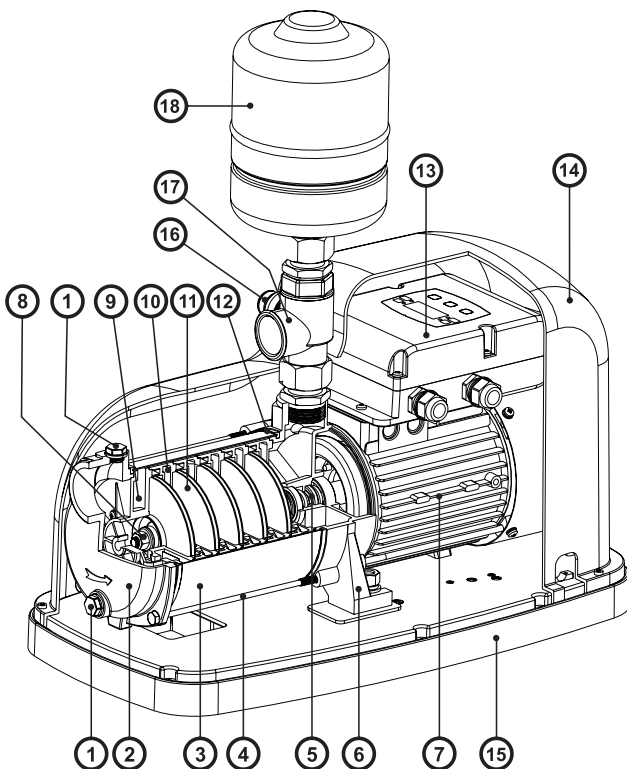

Item	Description	Materials
1	Prime and drain plugs	Bronze
2	Suction mounting	Cast iron
3	Pump housing	304 stainless steel
4	Tie bolt	Stainless steel
5	Mechanical seal	Graphite, silicon carbide, NBR
6	Discharge mounting	Cast iron
7	Motor	Class F IP55
8	Nut	304 stainless steel
9	Self-priming cover	PPO
10	Diffuser	PPO
11	Impeller	304 stainless steel
12	Casing O-ring	EPDM
13	Controller	ABS
14	Pump cover	PP
15	Pump base	PP
16	Sensor	Standard
17	Joint	Bronze
18	Pressure tank	Cold-rolled steel with diaphragm

## TYPICAL INSTALLATION

### Typical usage of JET-MHS BOOSTER pump

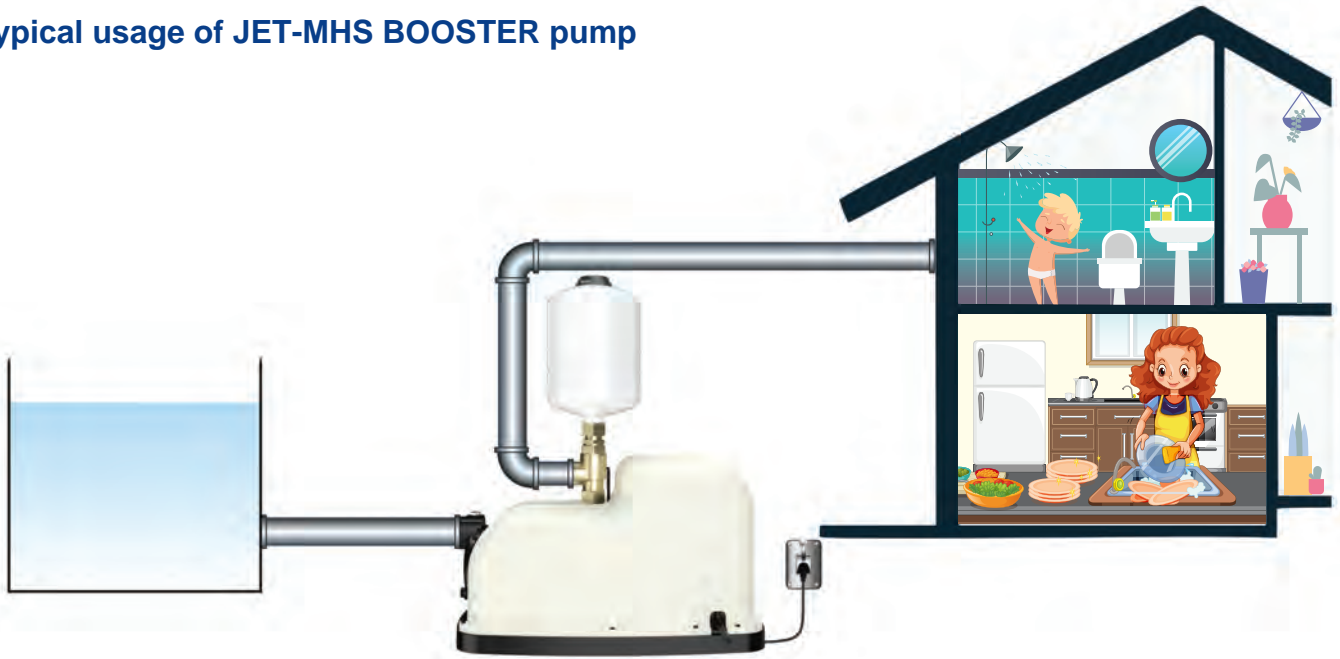

## DIMENSION

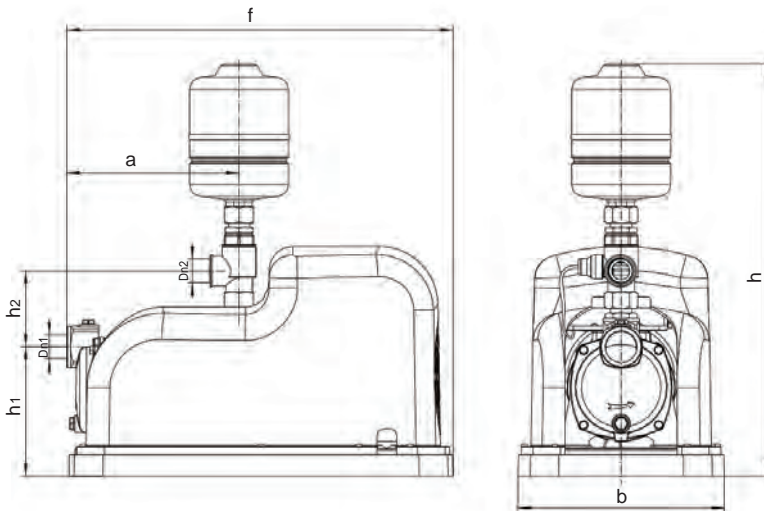

PUMP MODEL	Dn <sub>1</sub>	Dn <sub>2</sub>	DIMENSION [mm]					
			f	a	h	h <sub>1</sub>	h <sub>2</sub>	b
JET-MHS 60-2M	1"	1"	492	146	533	167	89	264
JET-MHS 60-3M	1"	1"	492	170.5	533	167	89	264
JET-MHS 60-4M	1"	1"	492	194.5	535	169	94	264
JET-MHS 60-5M	1"	1"	492	219	535	169	94	264
JET-MHS 60-6M	1"	1"	512	243.5	535	169	94	264
JET-MHS 90-2M	1"	1"	492	146	533	167	89	264
JET-MHS 90-3M	1"	1"	492	170	535	169	94	264
JET-MHS 90-4M	1"	1"	492	194.5	535	169	94	264
JET-MHS 90-5M	1"	1"	492	219	535	169	94	264
JET-MHS 90-6M	1"	1"	512	243.5	535	169	94	264
JET-MHS 120-2M	1.25"	1"	492	145.5	535	169	94	264
JET-MHS 120-3M	1.25"	1"	492	170	535	169	94	264
JET-MHS 120-4M	1.25"	1"	492	194.5	535	169	94	264
JET-MHS 120-5M	1.25"	1"	492	219	535	169	94	264
JET-MHS 120-6M	1.25"	1"	517	246.5	557	182	103	264
JET-MHS 145-2M	1.25"	1"	492	145.5	535	169	94	264
JET-MHS 145-3M	1.25"	1"	492	170	535	169	94	264
JET-MHS 145-4M	1.25"	1"	492	194.5	535	169	94	264
JET-MHS 145-5M	1.25"	1"	494	222	557	182	103	264
JET-MHS170-2M	1.25"	1.25"	492	149	565	170	124	264
JET-MHS170-3M	1.25"	1.25"	492	173.5	565	170	124	264
JET-MHS170-4M	1.25"	1.25"	492	197.5	590	182	130	264
JET-MHS170-5M	1.25"	1.25"	494	222	590	182	130	264

\* Dimensional details are provided for reference only.

\* All specifications are subject to change without prior notice.



**EBARA Pumps Malaysia Sdn Bhd**

6, Jalan TP3, UEP Subang Jaya Industrial Park,  
47620 Subang Jaya, Selangor, Malaysia.

Tel : 03-8023 6622 Fax : 03-8023 9355

Email : sales.epm@ebara.com

Website : www.ebara.com.my



Authorised dealer: