



EBARA

CF4101UE

EBARA GEAR PUMPS

Model GPE, GPF

"Model 000" in this catalogue is our model code.

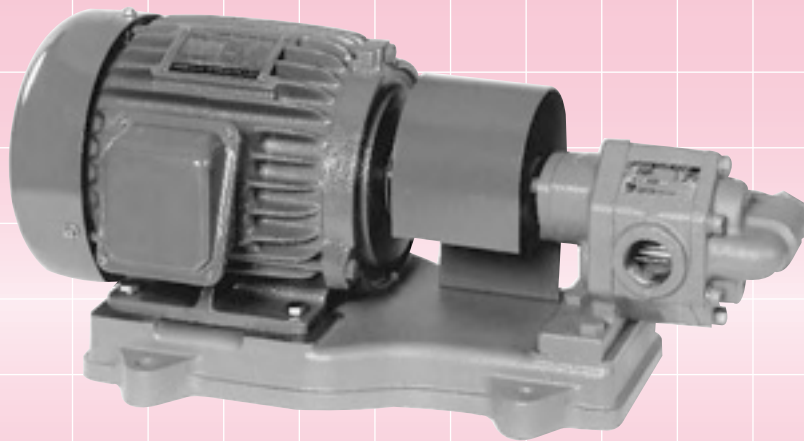

MODEL GPE GPF

EBARA GEAR PUMPS

《Model GPE》 Gland Packing Type

Max. discharge pressure
0.3MPa

Standard Specifications

Model		GPE
Item	Liquid Type	A.B.C. Heavy Oil, Turbine Oil
	Temperature	0-70°C
	Viscosity	7-500mm ² /s {cSt}
Suction Head		-0.03MPa {-0.3kgf/cm ² }
Max. Suction Pressure		0.1MPa {1kgf/cm ² }
Construction	Seal	Gland Packing
	Bearing	Needle Type Roller Bearing
Connection		Screw Type
Material	Casing	Cast Iron {FC200}
	Gear	Carbon Steel {S45C}
	Shaft	Carbon Steel {S45C}

Standard Accessories

Safety valve (Installed in pump) ...1
Common base1
Coupling1
Coupling guard1

Technical Data

50Hz

(Motor Synchronous Speed:1500min⁻¹
Capacity is the case of turbine oil 60mm²/s {cSt} use.)

Size	Connection	Type	Pole	Output (kW)	Max. Discharge Pressure (MPa) {kgf/cm ² }	Capacity (L/min.)
12	Rc-3/8	12GPE	4	0.2	0.3 {3}	6
15	Rc-1/2	15GPE	4	0.4	0.3 {3}	10
20	Rc-3/4	20GPE	4	0.4	0.3 {3}	20
25	Rc-1	25GPE	4	0.75	0.3 {3}	40

Technical Data

60Hz

(Motor Synchronous Speed:1800min⁻¹
Capacity is the case of turbine oil 60mm²/s {cSt} use.)

Size	Connection	Type	Pole	Output (kW)	Max. Discharge Pressure (MPa) {kgf/cm ² }	Capacity (L/min.)
12	Rc-3/8	12GPE	4	0.2	0.3 {3}	7
15	Rc-1/2	15GPE	4	0.4	0.3 {3}	12
20	Rc-3/4	20GPE	4	0.4	0.3 {3}	24
25	Rc-1	25GPE	4	0.75	0.3 {3}	48

《Model GPF》 Mechanical Seal Type

Max discharge pressure
1.0MPa

Standard Specifications

Model		GPF
Item	Liquid Type	A.B.C. Heavy Oil, Turbine Oil
	Temperature	0-80°C
	Viscosity	5-500mm ² /s {cSt}
Suction Head		-0.05MPa {-0.5kgf/cm ² }
Max. Suction Pressure		0.1MPa {1kgf/cm ² }
Construction	Seal	Mechanical Seal
	Bearing	Needle Type Roller Bearing
Connection		Screw Type
Material	Casing	Cast Iron {FC200}
	Gear	Carbon Steel {S45C}
	Shaft	Carbon Steel {S45C}

Standard Accessories

Safety valve (Installed in pump) ...1
Common base1
Coupling1
Coupling guard1

Technical Data

50Hz

(Motor Synchronous Speed:1500min⁻¹
Capacity is the case of turbine oil 60mm²/s {cSt} use.)

Size	Connection	Type	Pole	Output (kW)	Max. Discharge Pressure (MPa) {kgf/cm ² }	Capacity (L/min.)
12	Rc-3/8	12GPF	4	0.2	0.4 {4}	8.5
				0.4	1.0 {10}	8.5
15	Rc-1/2	15GPF	4	0.4	0.4 {4}	17
				0.75	1.0 {10}	17
20	Rc-3/4	20GPF	4	0.75	0.4 {4}	31
				1.5	1.0 {10}	31
25	Rc-1	25GPF	4	1.5	0.6 {6}	54
				2.2	1.0 {10}	54
32	Rc-1 1/4	32GPF	4	2.2	0.4 {4}	75
				3.7	1.0 {10}	75
40	Rc-1 1/2	40GPF	4	2.2	0.6 {6}	105
				3.7	1.0 {10}	105

Technical Data

60Hz

(Motor Synchronous Speed:1800min⁻¹
Capacity is the case of turbine oil 60mm²/s {cSt} use.)

Size	Connection	Type	Pole	Output (kW)	Max. Discharge Pressure (MPa) {kgf/cm ² }	Capacity (L/min.)
12	Rc-3/8	12GPF	4	0.2	0.4 {4}	10
				0.4	1.0 {10}	10
15	Rc-1/2	15GPF	4	0.4	0.4 {4}	21
				0.75	1.0 {10}	21
20	Rc-3/4	20GPF	4	0.75	0.4 {4}	37
				1.5	1.0 {10}	37
25	Rc-1	25GPF	4	1.5	0.6 {6}	65
				2.2	1.0 {10}	65
32	Rc-1 1/4	32GPF	4	2.2	0.4 {4}	90
				3.7	1.0 {10}	90
40	Rc-1 1/2	40GPF	4	3.7	0.4 {4}	125
				5.5	1.0 {10}	125

Suction Strainer (Special Accessories)

• Model 12-40STU (Single Type)

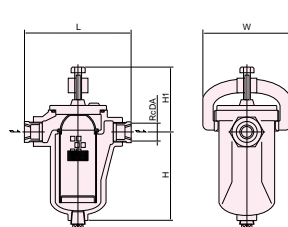

Type	Body					Filter Tube		Mass (kg)
	Rc	H	H1	L	W	D1	H2	
STU12	3/8	85	90	146	120	40	60	3
STU15	1/2	85	90	120	120	40	60	3
STU20	3/4	135	105	183	140	60	110	4
STU25	1	135	105	150	140	60	110	4
STU32	1 1/4	200	140	248	180	87	170	10
STU40	1 1/2	200	140	210	180	87	170	10

• Model 12-40STW (Duplex Type)

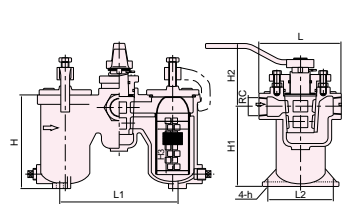

Type	Body					Fitting			Filter Tube		Mass (kg)
	Rc	H	H1	L	W	L1	L2	h	D1	H2	
STW12	3/8	115	92	115	146	125	90	12	40	60	7
STW15	1/2	115	92	115	120	125	90	12	40	60	7
STW20	3/4	170	145	120	183	215	120	12	60	110	15
STW25	1	170	145	120	150	215	120	12	60	110	15
STW32	1 1/4	225	195	150	250	250	120	15	70	150	21
STW40	1 1/2	250	220	150	210	265	130	15	87	170	30

• Model STU-50 (Single Type) Frange:JIS 10K Mass:30kg

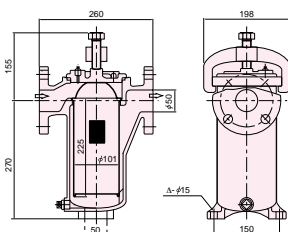

• Model STW-50 (Duplex Type) Frange:JIS 10K Mass:48kg

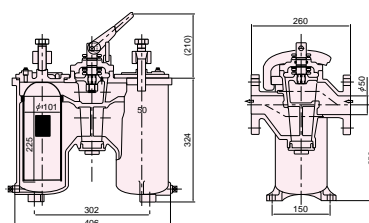

• Specification

- Gauge Roughness:60 mesh
- Effective Filtration Area: More than 8 times of strainer size
- Hydro Test Press of Case: 0.6MPa {6.2kgf/cm²}
- Max Allowable Normal Press: 0.3MPa {3kgf/cm²}

MODEL GPE GPF

EBARA GEAR PUMPS

Dimension (Model GPE)

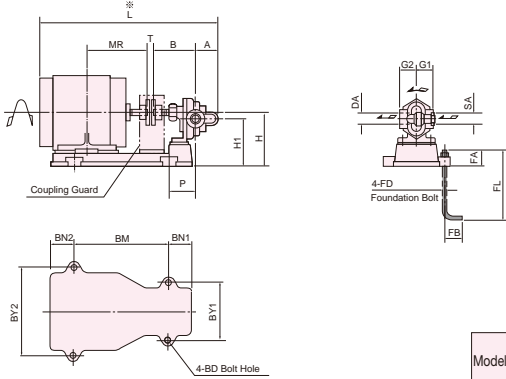

Unit:mm

Model	Type	Output (kW)	Pole	Connection (SA, DA)	Pump and Motor																Mass (kg)				
					A	B	H	H1	P	T	MR	L	G1	G2	BM	BN1	BN2	BY1	BY2	BD		FD	FL	FA	FB
GPE	12GPE	0.2	4	Rc- $\frac{3}{8}$	50	90	103	90.5	64	15	103	367	40	40	160	60	60	138	180	12	M10	200	40	40	12
	15GPE	0.4	4	Rc- $\frac{1}{2}$	50	100	111	96	65	15	120	416	40	40	180	60	60	138	194	12	M10	200	40	40	20
	20GPE	0.4	4	Rc- $\frac{3}{4}$	55	105	111	96	70	15	120	426	40	40	180	60	60	138	194	12	M10	200	40	40	20
	25GPE	0.75	4	Rc-1	65	117	135	115	70	15	140	480	50	50	220	60	60	168	214	12	M10	200	40	40	25

Dimension (Model GPF)

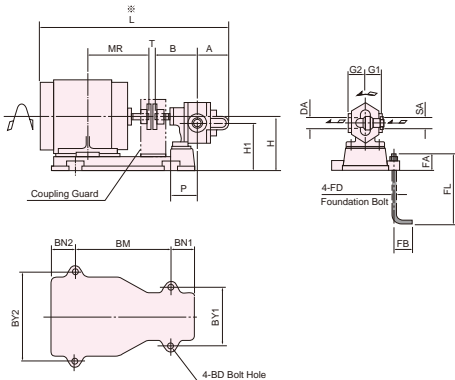

Unit:mm

Model	Type	Output (kW)	Pole	Connection (SA, DA)	Pump and Motor																Mass (kg)				
					A	B	H	H1	P	T	MR	L	G1	G2	BM	BN1	BN2	BY1	BY2	BD		FD	FL	FA	FB
GPF	12GPF	0.2	4	Rc- $\frac{3}{8}$	60	98	111	96	63	15	103	385	40	40	160	60	60	138	180	12	M10	200	40	40	14
		0.4	4	Rc- $\frac{3}{8}$	60	98	111	96	63	15	120	424	40	40	180	60	60	138	194	12	M10	200	40	40	21
	15GPF	0.4	4	Rc- $\frac{1}{2}$	65	103	111	96	68	15	120	434	40	40	180	60	60	138	194	12	M10	200	40	40	21
		0.75	4	Rc- $\frac{1}{2}$	65	103	125	110	68	15	140	466	40	40	210	60	60	138	214	12	M10	200	40	40	24
	20GPF	0.75	4	Rc- $\frac{3}{4}$	81	112	135	115	65	15	140	491	50	50	220	60	60	168	214	12	M10	200	40	40	27
		1.5	4	Rc- $\frac{3}{4}$	81	112	135	115	65	15	168.5	541	50	50	260	60	60	168	232	12	M10	200	40	40	37
	25GPF	1.5	4	Rc-1	89	120	135	115	73	15	168.5	557	50	50	260	60	60	168	232	12	M10	200	40	40	38
		2.2	4	Rc-1	89	120	145	125	83	15	193	599	50	50	270	70	80	168	264	12	M10	200	40	40	47
	32GPF	2.2	4	Rc-1 $\frac{1}{4}$	102	156	170	145	95	15	193	648	60	60	280	80	90	194	264	12	M10	200	40	40	52
		3.7	4	Rc-1 $\frac{1}{4}$	102	156	170	145	95	15	200	665	60	60	300	80	80	194	290	12	M10	200	40	40	62
	40GPF	2.2	4	Rc-1 $\frac{1}{2}$	108	162	170	145	101	15	193	660	60	60	280	80	90	194	264	12	M10	200	40	40	53
		3.7	4	Rc-1 $\frac{1}{2}$	108	162	170	145	101	15	200	677	60	60	300	80	80	194	290	12	M10	200	40	40	63
5.5		4	Rc-1 $\frac{1}{2}$	108	162	187	162	111	3	239	727	60	60	310	90	90	194	320	12	M10	200	40	40	89	

Strainer Resistance Curve

Model STU

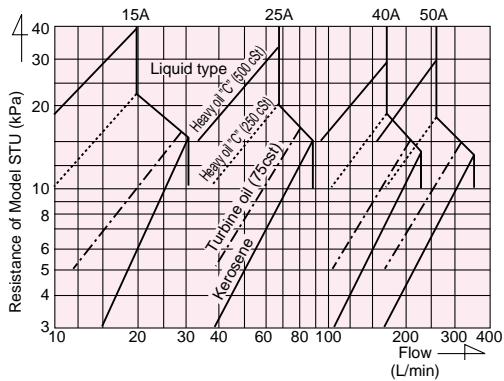

Model STW

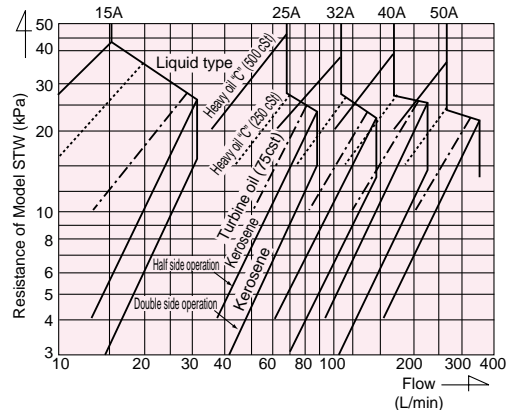

■ Viscosity Chart of Oil (Sample)

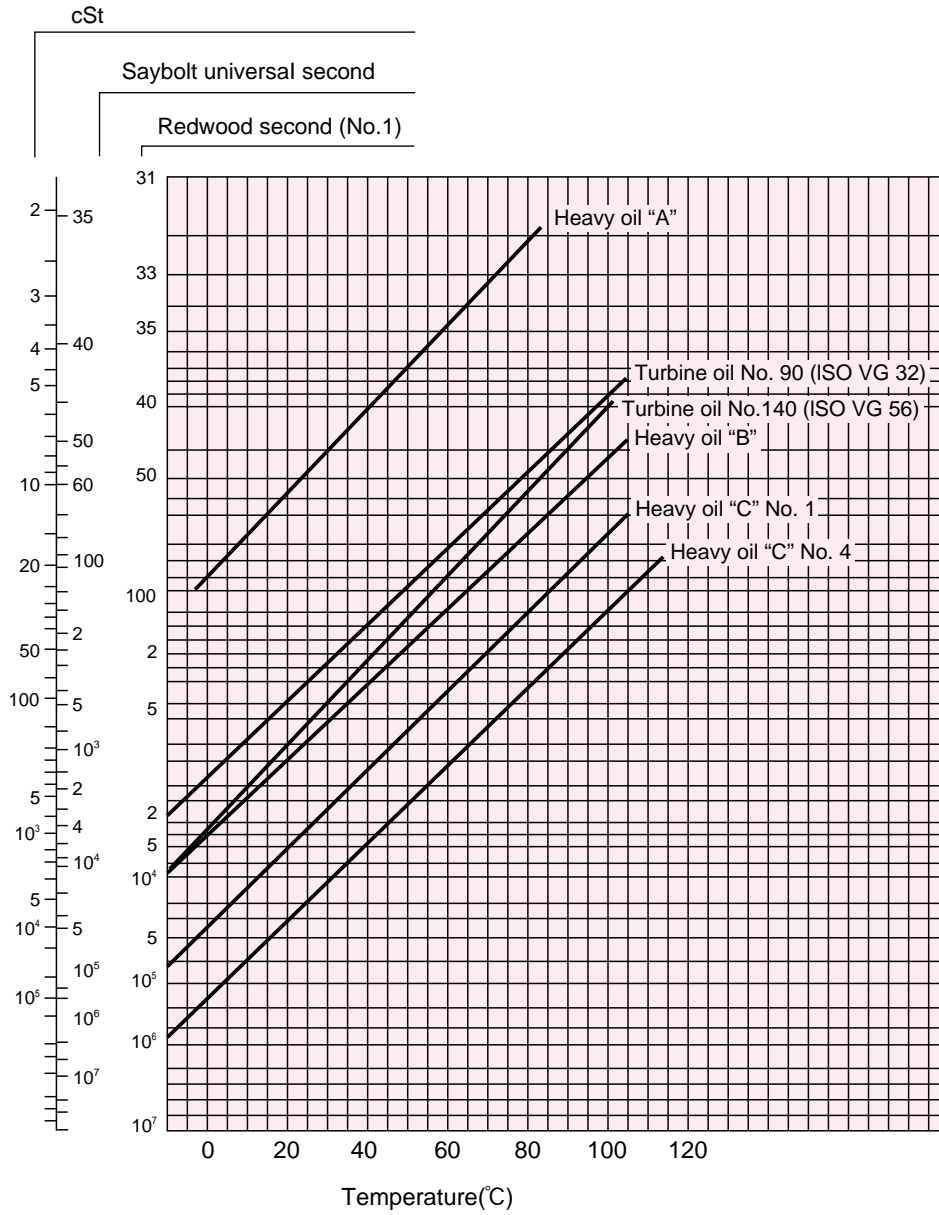

"Model ○○○" in this catalogue is our model code.



EBARA CORPORATION

**Standard Pump Business Division,
Sales Development Dept**

11-1 Haneda Asahi-cho, Ohta-ku, Tokyo 144-8510, Japan
 Phone:+81-3-6275-7578(direct) Fax:+81-3-5736-3193
 Website:<http://www.ebara.co.jp/en/>